

CHILD CAR SEAT

GROUP 0+

**SUITABLE FROM BIRTH – 13/15 MONTHS APPROXIMATELY
0 to 13kg (Birth to 29lbs)**

INSTRUCTIONS FOR FITTING AND USE

NOTICE

1. This is a "Universal" child restraint; it is approved to ECE Regulation 44.04 for general use in vehicles and will fit most, but not all, vehicle seats.
2. A correct fit is likely if the vehicle manufacturer has declared in the vehicle handbook that the vehicle is capable of accepting a "Universal" child restraint for this group.
3. This child restraint has been declared "Universal" under more stringent conditions than those applied to earlier designs which do not carry this notice.
4. If in doubt, consult either the child restraint manufacturer or the retailer.

Only suitable if the vehicle is fitted with 3-point static, 3-point retractor safety belts, approved to UN/ECE Regulation No. 16 or other equivalent standards.

EXTREME HAZARD

Do not use in passenger seats equipped with airbags (SRS)

THESE INSTRUCTIONS ARE IMPORTANT. PLEASE READ CAREFULLY AND RETAIN FOR FUTURE USE.

The correct use and maintenance of your car seat will ensure it gives long and trouble free use. When somebody else is using your car seat, ensure they also know how to use it, especially the correct way to adjust it. The safety of your child is your responsibility.

SAFETY WARNINGS

1. **PLEASE READ THOROUGHLY BEFORE COMMENCING INSTALLATION, AS AN INCORRECT INSTALLATION COULD BE DANGEROUS.**
2. **PARENTS SHOULD NOT UNDER ANY CIRCUMSTANCES USE THIS CHILD RESTRAINT ON A PASSENGER SEAT EQUIPPED WITH AN AIRBAG.**
3. The child seat must only be installed in the rearward facing position.
4. Never use the child seat without fastening the child's harness correctly, and never attempt to use it without fastening it into the car as described in these fitting instructions.
5. It is most important that the seat belt is correctly routed and the child seat tightened down on the upholstery as firmly as possible to ensure maximum protection – a recommended method is shown in these instructions.
6. Do not add to or modify this product in any way.
7. Never use this product if it has been in an accident, or if it has become badly worn. Periodically inspect the harness for wear, paying particular attention to attachment points, stitching and adjusting devices.
8. Do not leave a child in the seat unattended at any time.
9. Ensure that no part of the seat or seat belt is trapped in a door or a folding seat. If your car has a folding rear seat, ensure that it is correctly latched in its upright position.
10. Car interiors can become very hot when left standing in direct sunlight – it is therefore recommended that the child seat, when not in use, is covered by a towel etc. This prevents components, particularly those attached to the child seat, becoming hot and burning the child.
11. In the event of an emergency it is important that the child can be released quickly. This means that the buckle is not fully tamperproof and therefore your child should be persuaded never to play with the buckle.
12. Luggage and other heavy objects should be secured in the car. Loose objects are liable to cause injury in the event of an accident.
13. The child seat must not be used without the cover.
14. Never place your child seat on a table or work surface.
15. This seat can be used for children of 0–13kg in weight (approximately birth to 13/15 months of age) and is used in conjunction with a 3-point lap and diagonal safety belt in the rear-facing position only.
16. When the child seat is not in use, it is recommended that it is fastened into the car with a seat belt to avoid it being thrown about in the event of an accident.
17. In an emergency your child can be released quickly by pressing the red button on the harness buckle.
18. Store this child seat in a safe place when it is not being used. Avoid placing heavy objects on top of it.
19. If you travel with passengers using both the front and rear passenger seats, the lighter occupants should be in the rear and the heavier occupants in the front of the vehicle.
20. Do not allow your child seat to come into contact with corrosive substances e.g. battery acid.

GETTING TO KNOW YOUR CHILD SEAT

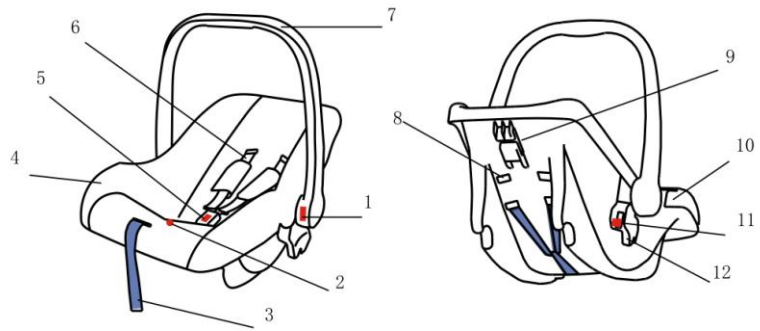

- | | | | |
|----|--------------------------------|----|-------------------------------|
| 1 | Red Button Handle Adjuster | 5 | Harness Buckle |
| 2 | Harness Adjuster under "Press" | 6 | Shoulder Straps |
| 3 | Harness Adjuster Strap | 7 | Carry Handle |
| 4 | Cover | 8 | Shoulder Harness Slots |
| | | 9 | Dark Blue Diagonal Belt Guide |
| | | 10 | Light Blue Lap Belt Guide |
| 11 | Red switch | 12 | Coupler |

THE HARNESS

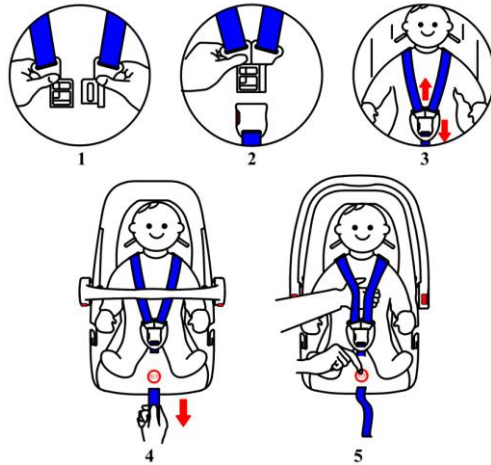

FASTENING THE HARNESS

- Step A. Slot the two plastic sections of the buckle connectors together Fig 1
- Step B. Slot the two connectors into the hole in the top of the buckle until they “click” into place Fig 2
- Step C. Always check that the harness is correctly locked by pulling above and below the buckle Fig 3
- Step D. The harness should be adjusted as tightly as possible without causing discomfort to the child. A loose harness is dangerous and should be checked each time that you use the seat. To tighten the harness, pull down on the adjustment strap until the harness is the correct tightness Fig. 4
- Step E. The harness is loosened by pulling on both straps at the same time press down on the harness adjuster that is located on the shell underneath the “Press” word stitched on the cover Fig. 5

UNFASTENING THE HARNESS

To release the harness, push the red button in the middle of the harness buckle inwards. You can now lift your child from the seat; ensure that the buckle connectors do not catch on clothing.

ADJUSTING THE SHOULDER HEIGHT

The harness has 2 positions. The straps should go into the slots at, or the nearest slots above the height of the child's shoulders. To adjust the harness, remove each strap by passing it through the slots from the front to the back of the seat; re-route the straps through the appropriate slots



FITTING YOUR CAR SEAT INTO THE CAR

WARNING: This car seat can only be fitted into the passenger seat of a car with a lap and diagonal seat belt and no air bag.

THE TYPE OF APPROVED SEAT BELT YOU MUST HAVE

Your child seat can only be installed rearward facing using a lap and diagonal seat belt in the front or rear passenger seat of the car.

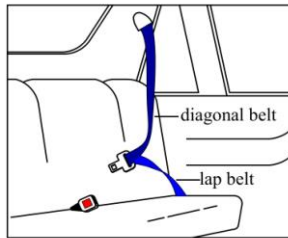

INSTALLATION

Step 1. Push the child seat facing rearward firmly against the backrest of the car's seat.

Step 2. Route the lap section of the adult safety belt through the lap belt guides and fasten the car seat belt.

Step 3. Place the diagonal belt in the diagonal seat belt guide at the back of the seat.

Step 4. Take out all the slack in the seat belt, ensuring that there are no twists or kinks in the seat belt...

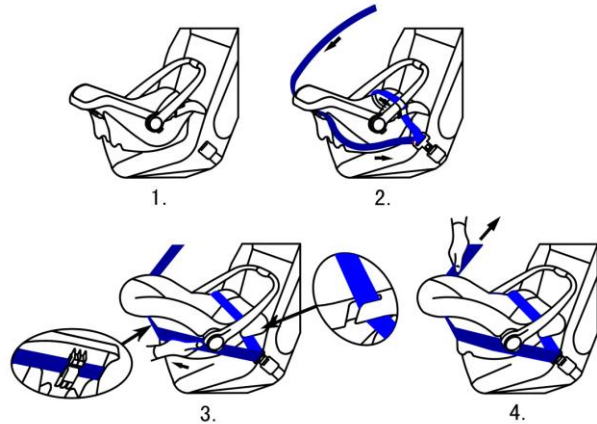

THE HANDLE POSITIONS

To adjust the handle from one position to another, pull out both sides of the handle on the swivel point; rotate the handle forwards or backwards into the desired position:

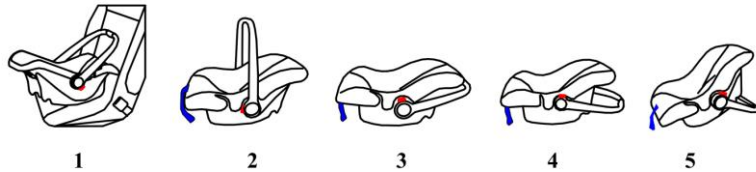

The carry handle has four positions:

- 1 Forward in the car
- 2 Straight up for carrying
- 3 Against the car seat for rocking
- 4 All the way down to support baby for feeding and play
- 5 Stop rocking.

Always ensure that the handle is locked in position and that the harness is correctly fitted and the buckle fastened before lifting your car seat.

CANOPY Assembly

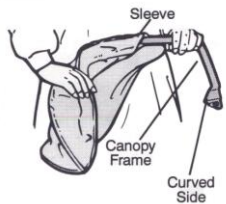

1 Insert frame through sleeve of canopy.

NOTE: Curved side of canopy frame must point towards canopy material.

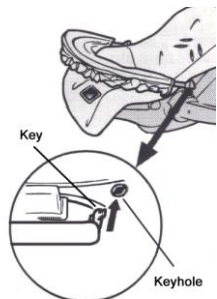

2 Insert keys on both ends of canopy frame into keyholes on car seat casting located above handle hubs.

Rotate canopy frame back.

HINT: It may be helpful to detach side of seat pad to see keyholes.

This child seat can be installed into the appointed stroller as the travel system.

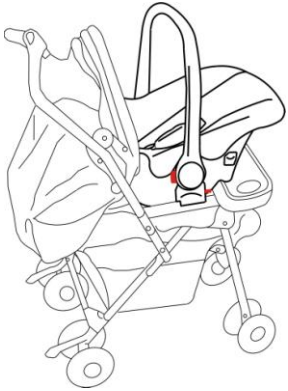

INSTALLING: position the coupler on the slot of the stroller, then press down the coupler into the slot until you hear a “click” signing the coupler is locked.

Very important: please make sure you hear a “click”. You can try to pull up and forward the child seat to confirm the coupler is locked.



TAKING DOWN: hold the child seat, lift the red switch of the coupler with your fingers then take the child seat out.

CARE OF YOUR PRODUCT

REMOVING THE COVER

The fabric cover can be easily removed for washing. Remove the harness by gently feeding the harness straps through from the front to the back of the seat, the crotch strap including the buckle should be removed; turn the metal slide underneath the shell on its side and feed it through the shell until the strap is free. Remove the cover and machine wash at 30°, line dry only.

To replace the fabric cover, follow reverse of the above.

CLEANING THE SEAT

The harness and plastic parts can be sponged with very mild detergent and warm water. Do not use chemical cleansers, bleach or corrosives on any part of the seat.