

CHILD CAR SEAT GROUP 2+3

Suitable for 15kg to 36kg
(3 to 12 years approx)

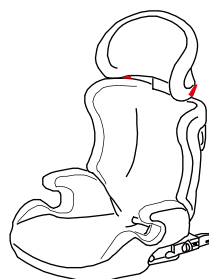

FITTING INSTRUCTIONS

NOTICE

1. This is a "Universal" child restraint; it is approved to ECE Regulation 44.04 for general use in vehicles and will fit most, but not all, vehicle seats.
2. A correct fit is likely if the vehicle manufacturer has declared in the vehicle handbook that the vehicle is capable of accepting a "Universal" child restraint for this group.
3. This child restraint has been declared "Universal" under more stringent conditions than those applied to earlier designs which do not carry this notice.
4. If in doubt, consult either the child restraint manufacturer or the retailer.

Only suitable if the vehicle is fitted with 3-point static, 3-point retractor safety belts, approved to UN/ECE Regulation No. 16 or other equivalent standards.

EXTREME HAZARD

Do not use in passenger seats equipped with airbags (SRS)

WARNINGS

THESE INSTRUCTIONS ARE IMPORTANT. PLEASE READ CAREFULLY AND RETAIN FOR FUTURE REFERENCE.

- PLEASE READ THOROUGHLY BEFORE COMMENCING INSTALLATION AS AN INCORRECT INSTALLATION COULD BE DANGEROUS.
- DO NOT USE THIS CHILD SEAT IN PASSENGER SEATS EQUIPPED WITH AIRBAGS.
- This child seat can be used without the harness for children of 15 to 36kg in weight.(approx. 3 to 12years)
- This child seat can only be installed forward facing using a three-point lap and diagonal seat belt.
- Do not use this child seat in the home. It has not been designed for home use and should only be used in your car.
- The safest seating position for this child car seat is on the rear seat of a vehicle.
- Never use the child seat without fastening the child's harness correctly, and never attempt to use it without fastening it into the car.
- Do not add to or modify the seat in any way.
- Do not leave your child unattended in the seat at any time.
- Car interiors can become very hot when in direct sunlight, it is therefore recommended that the child seat should be covered when not in use. This prevents components, particularly those attached to the child seat, becoming hot and burning the child.
- In the event of an emergency it is important that the child can be released quickly. This means that the buckle is not fully tamper proof and so your child must be taught never to play with the buckle.
- Luggage and other heavy or sharp objects should be secured in the car. Loose objects are liable to cause injury in the event of an accident.
- Periodically inspect the harness for wear, paying particular attention to attachment points, stitching and adjusting devices.
- Store this child seat in a safe place when it is not being used. Avoid placing heavy objects on top of it. Do not allow your child seat to come into contact with corrosive substances e.g. battery acid.

PARTS AND FITTINGS

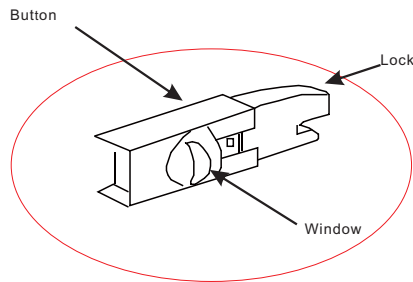
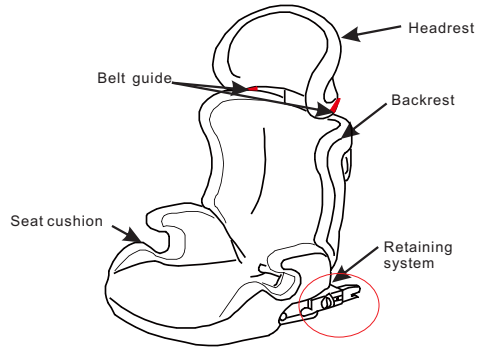

THE TYPE OF APPROVED SEAT BELT YOU MUST HAVE

WARNING: THE CAR SEAT SHOULD NOT BE FITTED IN A PASSENGER SEAT OF A CAR THAT HAS AN AIR BAG FITTED.(SRS)

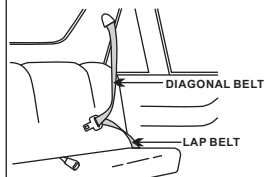

Your child seat can only be installed forward facing using a three-point lap and diagonal seat belt in the front or rear passenger seats of the car.

RETAINING SYSTEM

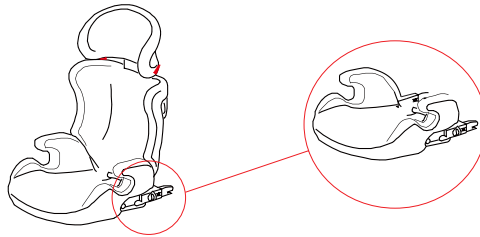

State Introduction

Initial state Rotate out when using



FIXED RETAINING SYSTEM on the car seat

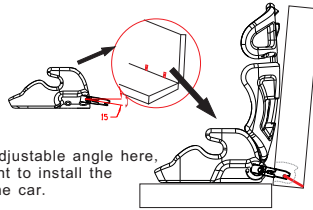

There is an adjustable angle here.
it is convenient to install the
car seat on the car.

Operation

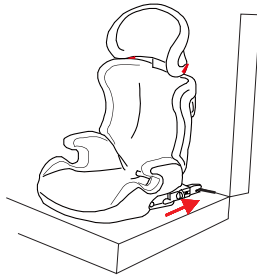

Push the car seat when in the unlock state.

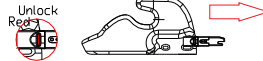

Lock it when you push at the end, the
Lock window appears to be Green.



Push the button backwards, the lock will be released.



ADJUST THE HEADREST HEIGHT

15-36kg

(approx. 3years to 11 years)



According to children's different height, the headrest can be adjusted up and down.

- Step1. Put your left (or right) hand on the backrest.
- Step2. Pull the red button with your another hand.
- Step3. Make the headrest up and down as your need. To make sure that the position fits for your child.

FITTING THE CAR SEAT USING THE BELT GUIDE

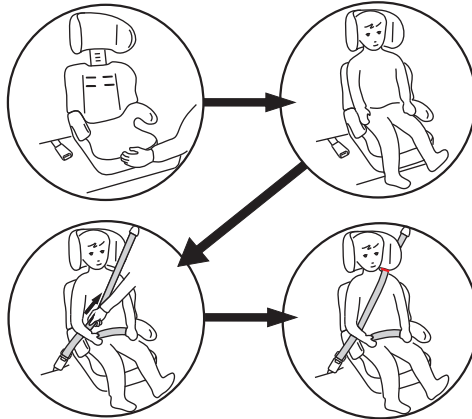

Step1. Place the child safety seat on the vehicle's seat ensuring it is firmly pressed against the car seat backrest.

Step2. Place the child in the child safety seat.

Step3. Fasten the seat belt, making sure that both sections of the seat belt webbing go under the armrest near the buckle, **the diagonal belt go through the red belt guide on the side of the headrest**. Check that the webbing has not become twisted and tighten the seat belt by pulling the diagonal strap upwards.

Make sure the seat belt has not become twisted. Also check that the cover is not impeding the movement or fit of the seat belt webbing in any way.
To release your child, simply unfasten the seat belt in the normal way.

ADJUST THE HEADREST HEIGHT

15-36kg

(approx. 3years to 11 years)

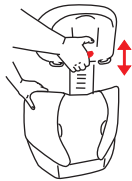

According to children's different height, the headrest can be adjusted up and down.

- Step1. Put your left (or right) hand on the backrest.
- Step2. Pull the red button with your another hand.
- Step3. Make the headrest up and down as your need. To make sure that the position fits for your child.

FITTING THE CAR SEAT USING THE BELT GUIDE AND RETAINING SYSTEM

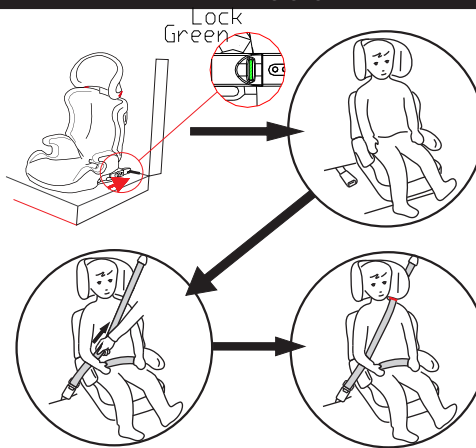

Step1. Place the child safety seat on the vehicle's seat ensuring it is firmly pressed against the car seat backrest.

Step2. Place the child in the child safety seat.

Step3. Fasten the seat belt, making sure that both sections of the seat belt webbing go under the armrest near the buckle, **the diagonal belt go through the red belt guide on the side of the headrest**. Check that the webbing has not become twisted and tighten the seat belt by pulling the diagonal strap upwards.

Make sure the seat belt has not become twisted. Also check that the cover is not impeding the movement or fit of the seat belt webbing in any way.
To release your child, simply unfasten the seat belt in the normal way.

CARE AND MAINTENANCE

THESE INSTRUCTIONS ARE IMPORTANT. PLEASE READ CAREFULLY AND RETAIN FOR FUTURE REFERENCE.

BACKREST COVER REMOVAL. First, release the elastic strap at the bottom of the backrest cover. Slide the cover off. The covers can now be cleaned.

HEADREST, BOOSTER SEAT COVER REMOVAL.
Slide the cover off. The covers can now be cleaned.

THE COVER SHOULD BE HAND WASH. Use only a mild hand soap and warm water. Do not use chemical cleaners and never attempt to bleach or dye the webbing. Allow to dry naturally.

IMPORTANT NOTE:

The child restraint must not be used without the cover.
The seat cover should not be replaced without one recommended by the manufacturer, because the cover constitutes an integral part of the restraint performance.
Don't use any car seat again after impact or accident.
Please remove the car seat out of vehicle when it is not used and keep out reach of child.
Please always fasten the car seat when it is inside the vehicle.
Please always read the manual before use it, and the manual is locate in the back of car seat, under the cover bag.

NOTICE

1. This is a "Universal" child restraint; it is approved to ECE Regulation 44.04 for general use in vehicles and will fit most, but not all, vehicle seats.
2. A correct fit is likely if the vehicle manufacturer has declared in the vehicle handbook that the vehicle is capable of accepting a "Universal" child restraint for this group.
3. This child restraint has been declared Universal under more stringent conditions than those applied to earlier designs which do not carry this notice.
4. If in doubt, consult either the child restraint manufacturer or the retailer.

Only suitable if the vehicle is fitted with 3-point static, 3-point retractor safety belts, approved to UN/ECE Regulation No. 16 or other equivalent standards.